

For Questions and Technical Support
Contact:



1801 South Notawa Road
Sturgis, MI 49091
(800) 233-4823

Latest version of all documents available at;
www.morganolsonparts.com/t-usps_manuals.aspx
Access code: usps2016



Keyless Entry System



***NOTE: SIDE DOORS AUTOMATICALLY LOCK WHEN CLOSED.
ALWAYS CARRY YOUR ELECTRONIC KEY FOB WITH YOU.***

KEYLESS ENTRY



This vehicle is equipped with a keyless system that utilizes a KEY FOB to unlock the cab doors without the use of a conventional key. The normal manual keyed locks are also provided for the passenger and driver side doors for backup operation.

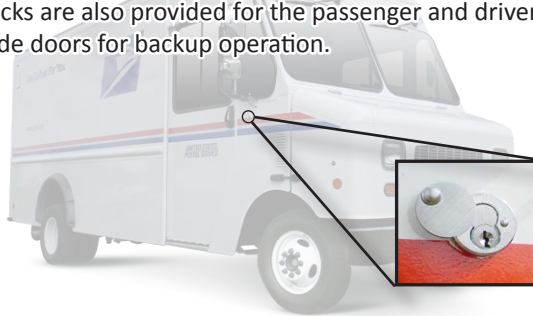

The key fob system uses a remote control that has a range of approximately 20 feet. Pressing the button once will unlock the passenger and driver side doors. The doors will relock if not opened within six seconds.

DOOR LOCK SWITCH

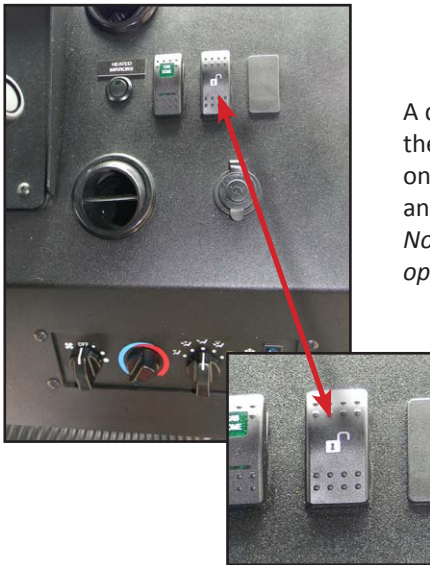

A door lock switch is located on the dash panel. Pressing the switch once will unlock both the passenger and driver side doors.

Note: The doors will relock if not opened within six seconds.

INSIDE MANUAL LOCK RELEASE

To manually unlock the doors from inside the cab area, slide the yellow knob forward.



The keyless entry control box is located above the windshield in the cab.

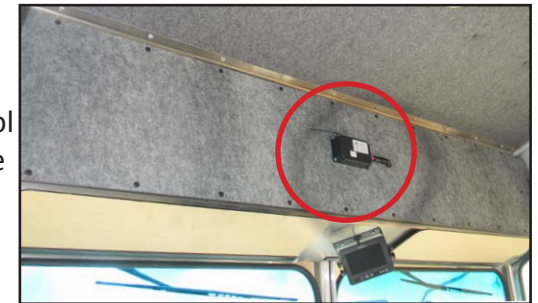

**FOR KEY FOB TROUBLESHOOTING AND PROGRAMMING
SEE MORGAN OLSON SERVICE MANUAL PAGE 78**